

# Friends of Perry Parks Membership Application

New Membership

Renewal Membership

Name

---

---

Address

---

---

---

Email

---

- Individual \$20.00
- Household \$35.00
- Business and Professional \$100.00
- Non-Profit \$50.00
- Additional Donation
- Pledge 8 volunteer hours in exchange for membership

Mail to:

Friends of Perry Parks  
Post Office Box 123  
Blue Mounds, WI 53517

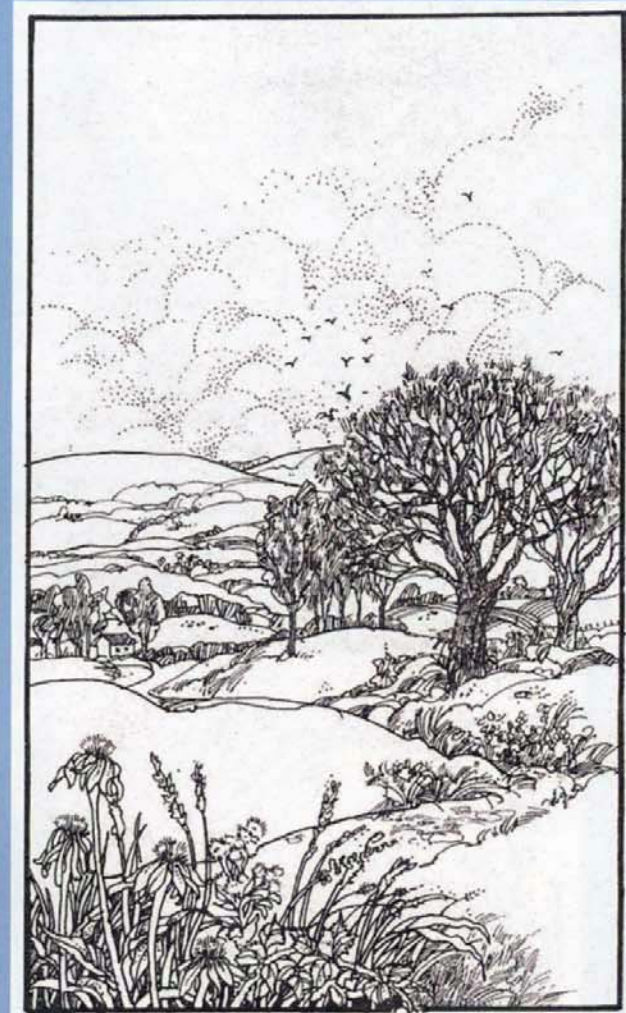

the **FRIENDS** of the **PARKS**  
of **PERRY TOWNSHIP**



 All contributions to the Friends of Perry Parks  
are tax deductible to the extent allowed by law



# The Parks of Perry

## Hauge Historic District Park

The Town of Perry established the 30 acre Hauge Historic District Park to provide the nation, region and local community with an inspiring respite from day to day life.

The Town will develop, through prairie restoration, the District Park in a manner that will maintain and enhance the character of the historic 1852 Hauge Log Church site while serving to provide its residents and the region with recreational

facilities for hiking, skiing, picnics, or other passive activities. This, the first park in the Town of Perry, will, as stated by the Perry Historic Preservation Commission "foster civic pride in the accomplishments of the past as well as promote its use for the education, pleasure and welfare of all people now and into the future

## Daleyville Community Park

The one-acre park located on the northwest side of Daleyville was donated to the Town in 2002. The park is being developed as a community based family park.

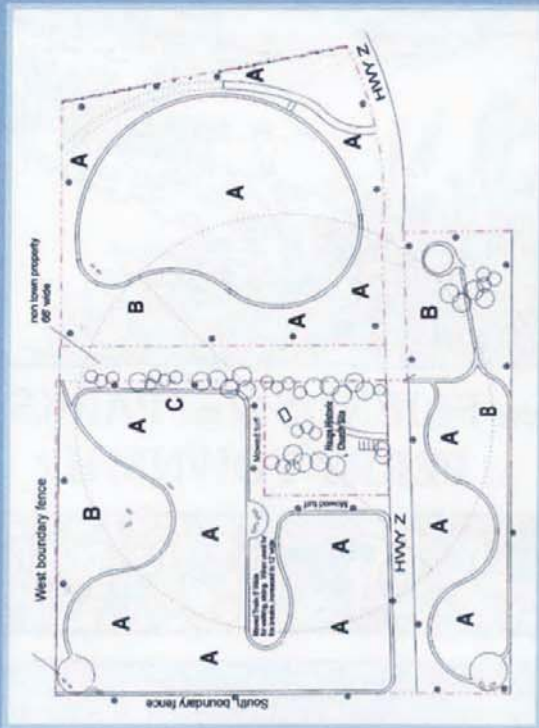

# Friends of Perry Parks

The Friends of the Parks of Perry Township, Inc., a non profit organization was established in 2004 to develop and maintain parks within Perry township. A variety of membership options are available, including a plan whereby residents can pledge eight hours of labor in the park in exchange for a one year membership. Membership dollars will be used to purchase seeds, plants and equipment for park development and maintenance. Future plans include a newsletter, and annual meeting and monthly work days in the parks.

The Friends of Perry Parks invite your participation. Please consider joining us to meet and work with your neighbors to help preserve these beautiful areas for future generations.

